

ALÜMİNYUM VE SAC ENDÜSTRİYEL ASMA TAVANLAR PANEL İKİZ—PANEL 200

ALUMINIUM AND SHEET INDUSTRIAL
SUSPENDED CEILINGS
ÜRÜNLERİMİZ TSEK BELGELİDİR.

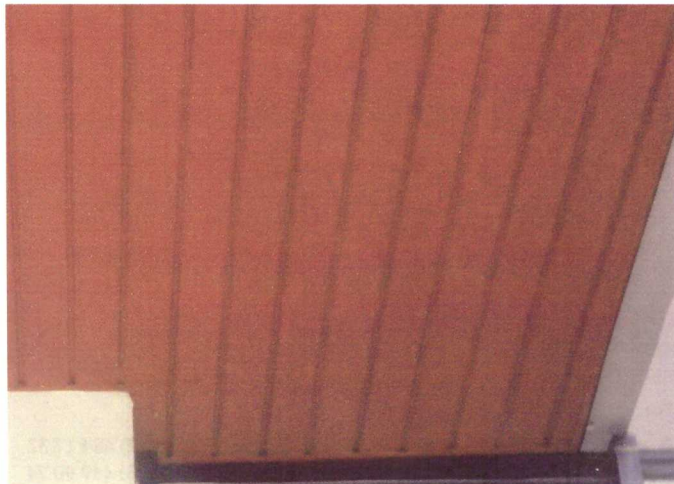

PANEL İKİZ

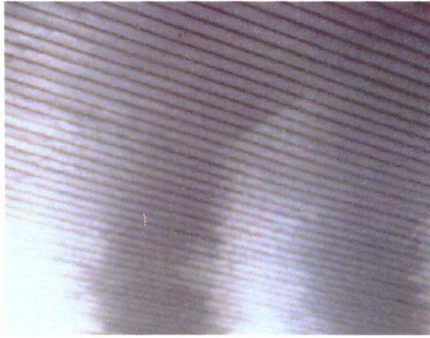
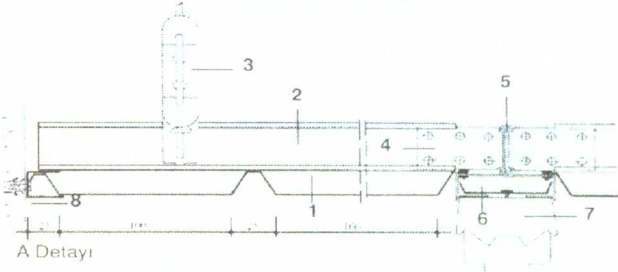
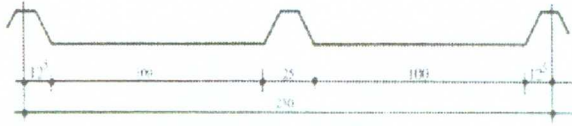
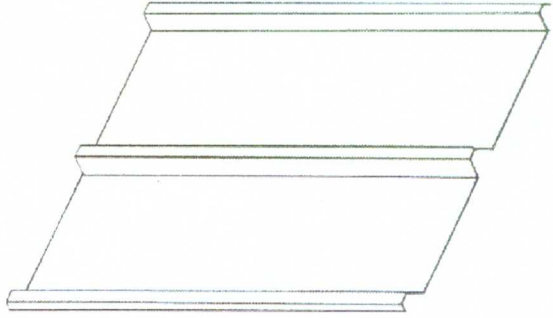

1. Panelikiz
2. Taşıyıcı T profil
3. Askı Takımı
4. Taşıyıcı ek parça
5. TMS armatür taşıyıcı profil
6. Armatür taşıma parçası
7. TMS floresan armatür
8. Kenar profil (18/20)

PANEL 200

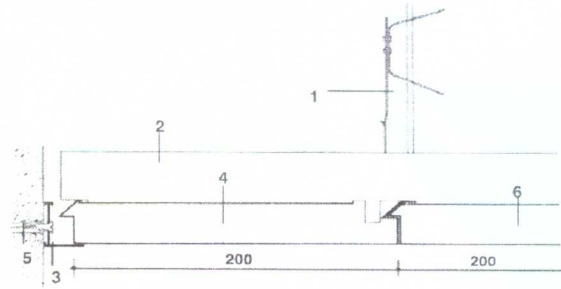
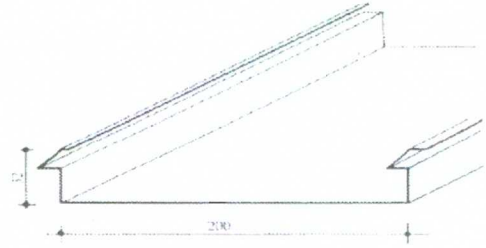

1. Askı takımı
2. Omega taşıyıcı
3. Kenar profili L
4. P 200
5. Dübel vida
6. P 200

PANEL İKİZ VE PANEL 200 ASMA TAVANLAR

MALZEME

- 0.50 - 0.60mm kalınlıkta alüminyum levha etial 0 alaşım tam sert veya 0.40 - 0.50mm galvanizli sac.
- Standart renk antik beyaz (RAL 9002).

İMALAT ÇEŞİTLERİ

- Düz, gofrelı, naturel, fırın boyalı, delikli (P-200).

KULLANIM YERLERİ

- İplik fabrikaları, atölyeler, akaryakıt istasyonları, terminal binaları, havaalanları

PANEL İKİZ AND PANEL 200 SUSPENDED CEILING

MATERIAL:

- 0.5 - 0.6mm Aluminium sheet etial 0 alloy, full hard, or 0.40 - 0.50mm galvanized sheet.

PRODUCTION TYPES:

- Smooth, goffered, naturel, stove-enameled, perforated (P-200)

PLACE OF USES:

- Fibre factories, workshops, petrol stations, terminals, airports



web sitesi : <http://www.mekon.com.tr>
e-mail: pazarlama@mekon.com.tr

Adres

MERKEZ (Head Office) : Fabrika Cad. No: 106

İRTİBAT (Liasion Office) : Bağdat Cad. Vedat Han No: 53/60 Kat: 1

Gölbaşı/ANKARA
Kızıltoprak/İSTANBUL

Telefon

(0,312) 484 62 74
(0,216) 449 90 73

Fax

(0,312) 484 17 32
(0,216) 449 90 74